

Made for Motion

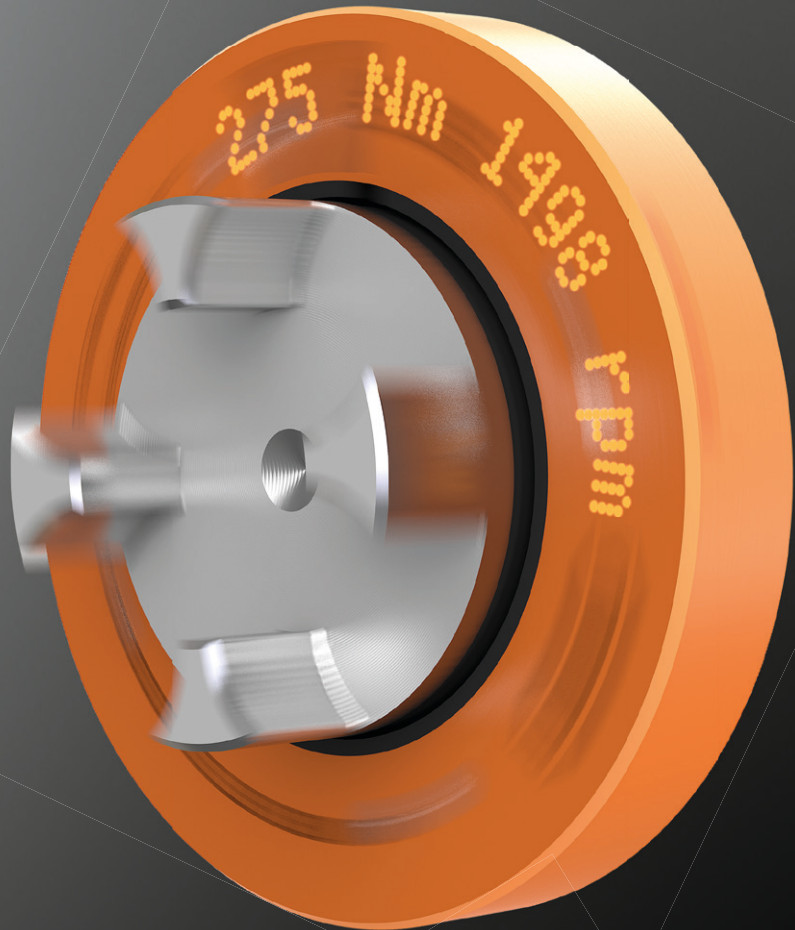

MONITEX[®] BT

Torque measuring coupling hub

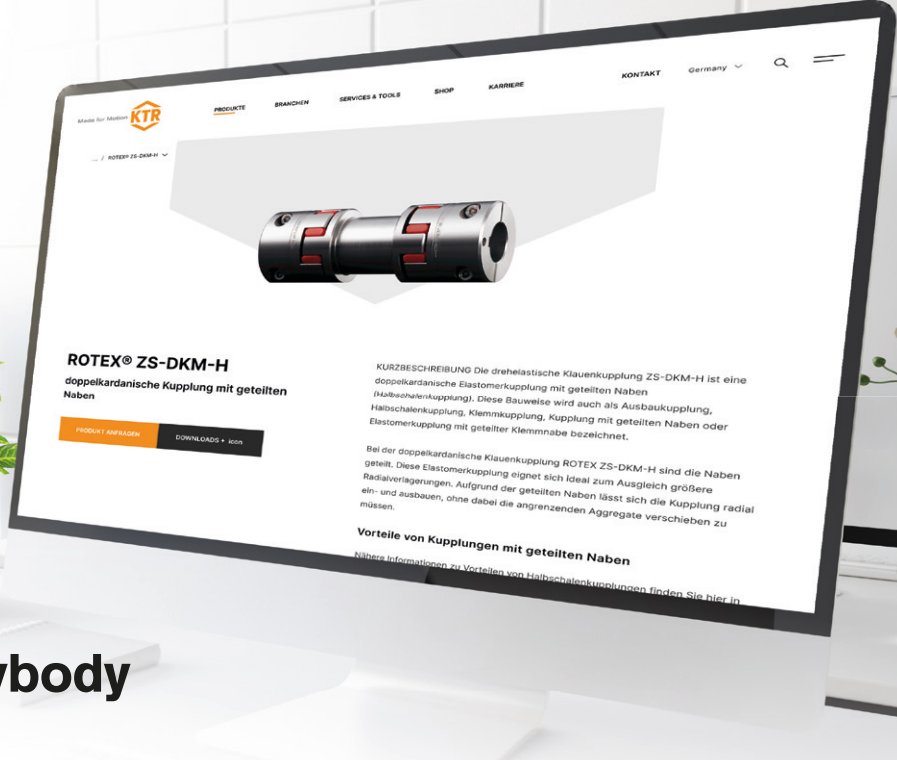

One for all and everybody

The new website will soon go online

There will be no alteration, no revision, nor merely a facelift: There will rather be a comprehensive relaunch of our website making our company, our products and our services digitally accessible in a more detailed and convenient way than ever before.

The conception stage of the relaunch project managed by Melanie Gunka and Julian Birich already started in September 2021. Initially numerous international specifications of requirements as well as in-house and external surveys were executed. The target was to provide only one digital platform for all in the future - accordingly for example integrate the platforms ktr360.com and ktr-events.com completely in the new website.

„The focus is definitely on improving the services and usability of the website for visitors“, Melanie Gunka underlines. „All contents are concentrated in one place and the performance is significantly

increased. The objective is to raise the user experience to a new level.“ For that purpose a new, comfortable and quick search function is integrated, as an example. The streamlined structure as well as links to products and services facilitate navigation and consequently locating the numerous offers of KTR. Besides, its responsive design makes the new website equally easy to access for all terminal devices. The login area is significantly facilitated as well: In the future customers only have to log in once to have access to all contents and applications, from miscellaneous downloads and services to 3D-CAD drawings.

After launching both the KTR configuration tools are to be natively embedded in the website and all national versions of the website are to be adapted in the course of 2023 - to make sure all customers are able to benefit from the advantages of our retreated website in the respective national language step by step worldwide.

Our 2D/3D publishers as an extension of our online tools

Having calculated the right product by means of the coupling configurator, you can be provided with the result as a 2D, 3D, dimensional drawing or as a 3D-PDF file as of now. What is special: Clicking the download the requested drawings and models are generated in real time in the background.



Online tools

Tailor-made to your specifications - make use of our online tools



MONITEX® BT 28/200, 42/800 TORQUE MEASURING COUPLING HUB

Examples of application



Machine monitoring

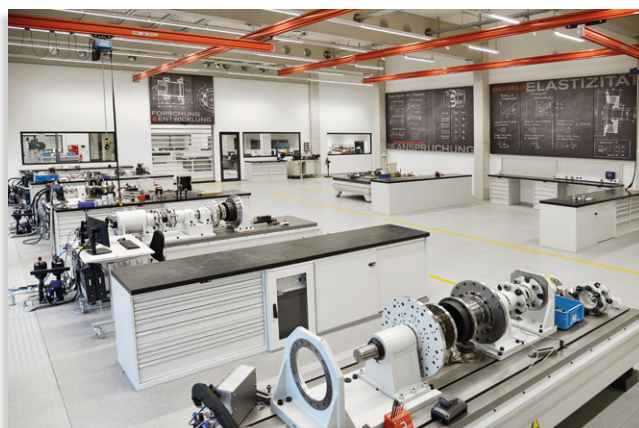

Test bench technology



Process management



Quality assurance

Mounted with a few steps, the new MONITEX® BT is a precise tool for daily measuring tasks in test bench technology. With the help of the apps or the PC software, torque and speed data can be displayed and saved in a matter of seconds.

Thanks to its compact dimensions it can also be used for machine monitoring and process control where integration of measuring shafts in a long version have previously failed.

The outputs of our analogue gateway directly supply the voltages for the PLC and the control. Furthermore, the data can be saved to a cloud via an edge device so that there is nothing impeding more complex monitoring.

Especially in quality assurance, it is often an advantage to not only save data, but also read them directly for setting purposes. The integrated display of the MONITEX® BT informs the user immediately and at any time about the current load on the drive.

MONITEX® BT 28/200, 42/800 TORQUE MEASURING COUPLING HUB

Description of product



ROTEX® goes digital – MONITEX® BT, the coupling hub that measures torque

MONITEX® BT is a backlash-free coupling hub that can measure torque and speeds. In contrast to classical torque measurement, the torque is no longer measured via an intermediate shaft or intermediate flange, but the measurement takes place inside the measurement hub. Thanks to this, the new measurement coupling can be integrated into the drive in a few simple steps, even when there is little space available.

The energy is transmitted contactlessly and permits a permanent operation of the measurement hub. To this end, the inductive energy transmitter is installed with a clearance of about max. 10 mm radially of the coupling.

As soon as the inductive head is switched on, the actual torque and speed data are sent by MONITEX® BT using Bluetooth and, using the free MONITEX® app, they can be received by a smart phone or a PC and saved. The "MONITEX® BT" app is available for Android and iOS Smartphone and can be downloaded from the app stores.



The data can be displayed in the app either as a curve progression or as numeric numbers. Minimum, maximum and average values are continuously calculated. The data is recorded during the measurement and can then be analysed afterwards. A visual and acoustic alert informs the user once the set limit values are exceeded or fallen below.

If you have a PC or laptop with Bluetooth connection, you can download the free KTR Windows software from our homepage. It permits a high scanning frequency of the torque signal of 500 Hz and provides the opportunity to save the data in a CSV file.





Limitless connectivity

In many cases, the user requires live data to feed into the system control for monitoring or controlling the drive train.

This can either be done by means of a DAC (digital-to-analogue converter), which establishes the connection to MONITEX® BT and outputs the torque and speed values as analogue voltage signals, or by means of an edge device, which connects the MONITEX® BT with the big data world.

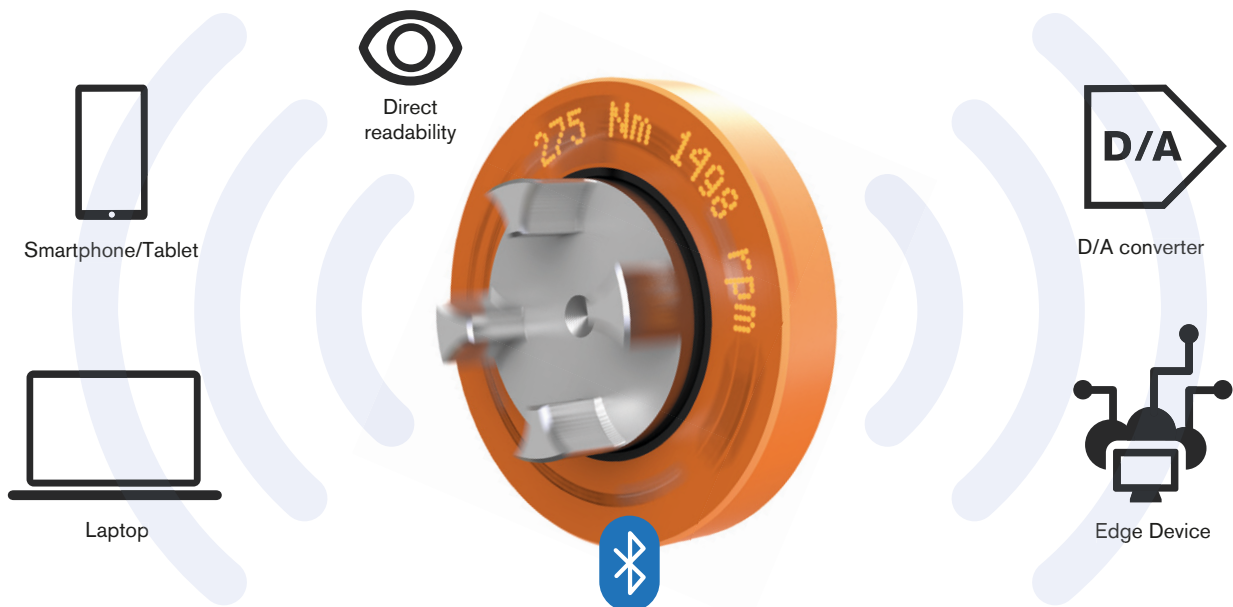
In addition to smartphone, edge device and analogue outputs, MONITEX® BT also has a display that shows the current torque and speed when in rotation. Like this, the data is also available even if you do not have your smartphone at hand or simple monitoring of the load is sufficient.



Connectivity				
Terminal device	Direct connection to MONITEX® BT	Preconditions	Measuring frequency torque/speed in Hz	Reference source
Android				
Smartphone	•	from Android Version 6	60 / 3	
Tablet	•			
iOS				
Smartphone	•	from iOS Version 15.5	60 / 3	
Tablet	•			
Windows				
PC	•	Windows 10, hardware with Bluetooth connection	500 / 5	www.ktr.com
Laptop	•			
Analogue gateway (DAC)	•	–	500 / 5	Contacting KTR
Edge gateway	•	Programming on consultation	500 / 5	Contacting KTR

MONITEX BT® 28/200, 42/800 TORQUE MEASURING COUPLING HUB

For torque ranges from 200 to 800 Nm

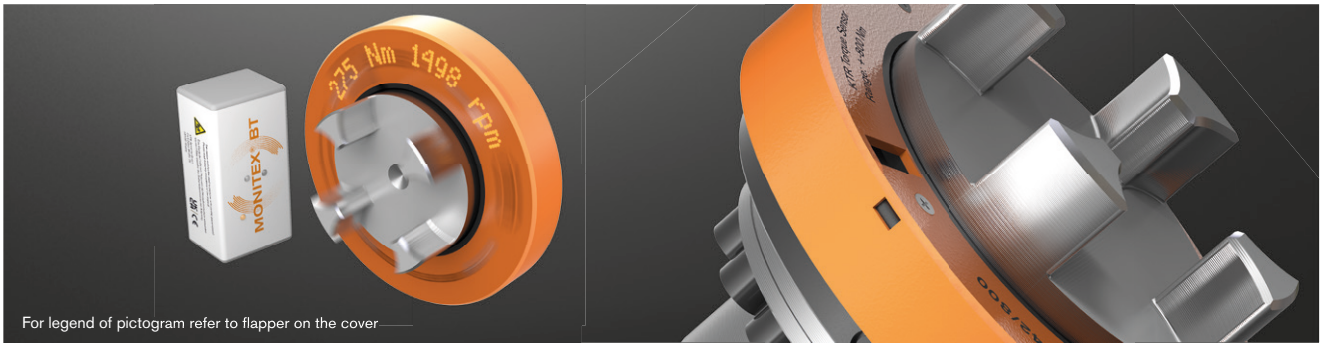

For legend of pictogram refer to flapper on the cover



General properties

MONITEX BT® type	Coupling type	Supply voltage in V ²⁾	Current consumption in mA ²⁾	Operating temperature range in °C
28/200	ROTEX® GS 28	24 ± 4	<200	0 ... 55
42/800	ROTEX® GS 42			

Technical data of torque signal

MONITEX BT® type	Measuring range T _{KN} in Nm	Inaccuracy in % von T _{KN}	Measuring frequency of app/Windows software in Hz	Influence of temperature ¹⁾ in %/10 °C
28/200	-200 ... +200	±0.25	60 / 500	0.05
42/800	-800 ... +800			

Technical data of speed signal

Measuring range T _{KN} in 1/min	Resolution in rpm	Measuring frequency of app/Windows software in Hz
30-3500	1	5/3

Technical data of display

Number of digits of torque	Number of digits of speed	Turn-on threshold in rpm
3+1 decimals + ± sign	4	300

Mechanical data of the coupling hub

MONITEX BT® type	Static load limit ¹⁾ T _K max in %	Breaking load T _K Bruch ¹⁾ in %	Max. bending torque in Nm	Max. radial force in N	Max. axial force in kN	Weight in kg	Torsion spring stiffness C _T in Nm/rad	Torsion angle with T _{KN} in degrees	Mass moment of inertia in kgmm ²	Max. speed in rpm
28/200	150	300	22	250	8	0.84	46000	0.25	765	3500
42/800			86	700	20	1.72	194000	0.24	2690	

¹⁾ Referring to rated torque T_{KN}
²⁾ MONITEX® BT inductive head

MONITEX® BT measuring coupling with coupling flange

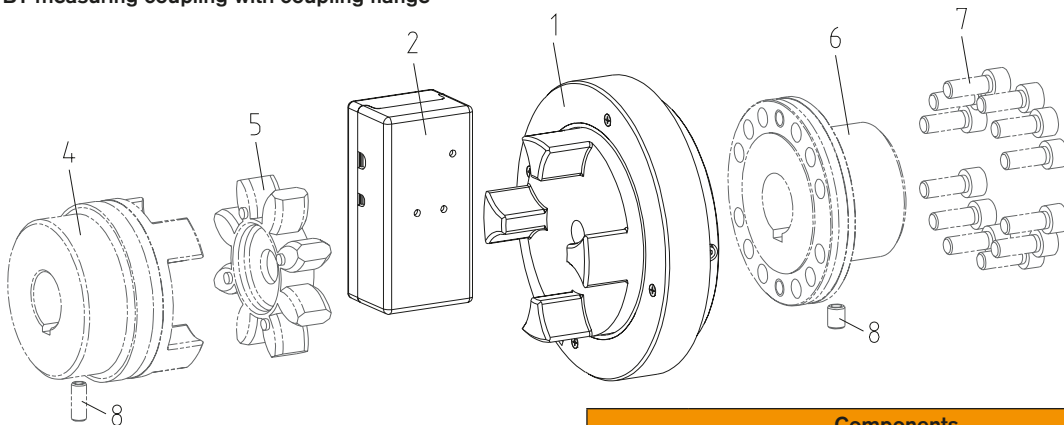

Components

Component	Quantity	Subassembly
1	1	MONITEX® BT measuring hub
2	1	MONITEX® BT inductive head (inductive current transmission)
3 ¹⁾	1	MONITEX® BT connection cable
4 ²⁾	1	ROTEX® GS coupling hub
5 ²⁾	1	ROTEX® GS spider
6 ²⁾	1	ROTEX® GS flange hub
7 ²⁾	see page 7	Cap screws DIN EN ISO 4762 - 12.9
8 ²⁾	2	Setscrew DIN EN ISO 4029

¹⁾ not shown graphically in the left image

²⁾ Optionally available

Ordering example:

MONITEX BT® 42/800	Inductive head	2 m	ROTEX® GS	ROTEX® GS spider
Coupling hub with measurement range	Inductive power supply	Connection cable	See catalogue "Drive Technology" on page 123	See catalogue "Drive Technology" on page 127

Components

MONITEX® BT measuring coupling

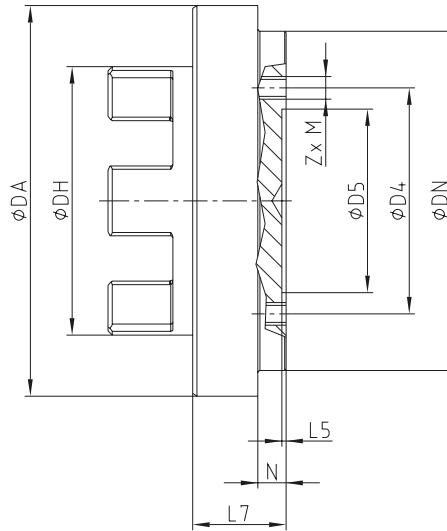

Dimensions [mm]									
MONITEX® BT type	DA	DH	DN	D4	D5	L5	L7	N	Z x M
28/200	112.4	65	90	54	44	1.5	28	10	8 x M6
42/800	138.4	95	120	80	65	1.5	33	10	12 x M8

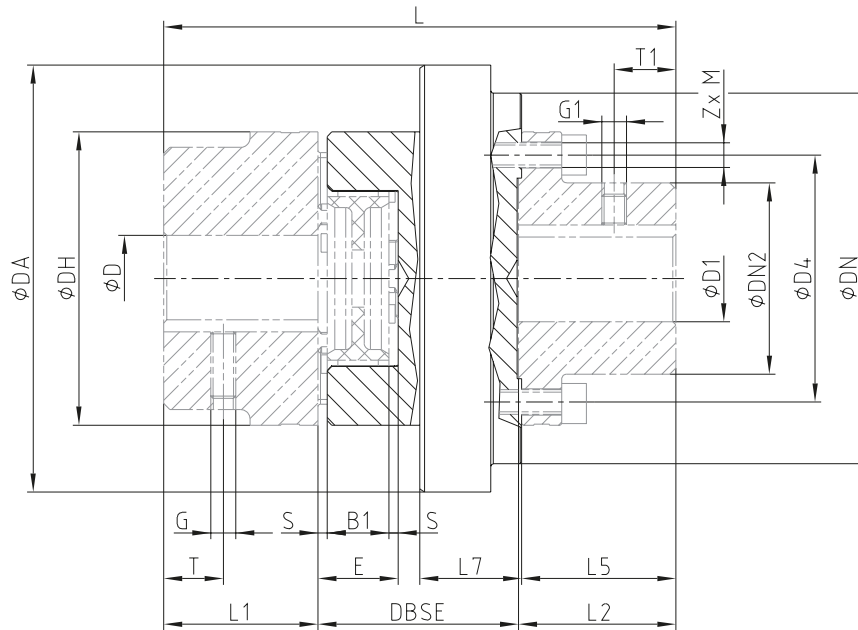

Dimensions in mm									
MONITEX® BT type	ROTEX® GS size	Max. finish bore		DA	DH	DBSE	DN	DN2	D4
		D	D						
28/200	28	35	30	112.4	65	54.5	90	42	54
42/800	42	55	45	138.4	95	65.0	120	62	80

Dimensions in mm											
MONITEX® BT type	L	L1	L2	L5	L7	E	B1	S	Cap screws DIN EN ISO 4762		
									Number Z	M	T _A in Nm
28/200	125	35	35.5	35	28	20	15	2.5	8	M6	17
42/800	166	50	51.0	50	33	24	18	3.0	12	M8	41

Setscrew DIN EN ISO 4029		
Size	28	42
Dimension G, G1 in mm	M8	M8
Dimension T, T1 in mm	15	20
Tightening torque T _A in Nm	10	10

NOTES

A large grid of graph paper, consisting of 24 columns and 45 rows of small squares, intended for writing notes.

KTR Germany:

Headquarters:

KTR Systems GmbH

Carl-Zeiss-Straße 25
D-48432 Rheine

Phone: +49 5971 798-0

Fax: +49 5971 798-698 or 798-450

E-mail: mail@ktr.com

Internet: www.ktr.com

KTR Brake Systems GmbH

Competence Center for Brake Systems

Zur Brinke 14
D-33758 Schloß Holte-Stukenbrock

Phone: +49 5207 99161-0

Mobile: +49 175 2650033

Leiter Vertrieb Bremsen Wind

Lino Gioroglou

Zur Brinke 14
D-33758 Schloß Holte-Stukenbrock

Phone: +49 5207 991 61-72

Mobile: +49 160 90 58 97 41

E-mail: l.gioroglou@ktr.com

Leiter Vertrieb Bremsen Industrie

Thomas Wienkotte, Dipl.-Ing. (FH)
Am Rott 18

D-50171 Kerpen

Phone: +49 2237 971 796

Mobile: +49 172 5859448

E-mail: t.wienkotte@ktr.com

Außendienst Norddeutschland für Hydraulik-Komponenten

Gunnar Ehlers

Finkenstieg 4b
21629 Neu Wulmstorf

Mobile: +49 174 3301536

E-mail: g.ehlers@ktr.com

Außendienst Bayern, Baden-Württemberg und Österreich für Hydraulik-Komponenten

Klaus-Peter Sprödhuber

Blumenstraße 6
95499 Harsdorf

Phone: +49 9203 9739450

Mobile: +49 172 1096496

E-mail: k.sproedhuber@ktr.com

Schleswig-Holstein, Nord-Niedersachsen, Hamburg, Bremen

Martin Lau, Maschinenbautechniker
KTR Ingenieurbüro Hamburg

Geschwister-Scholl-Allee 44
25524 Itzehoe

Phone: +49 4821 4050812

Mobile: +49 172 5310014

E-mail: m.lau@ktr.com

NRW: Großraum Düsseldorf, Köln, Aachen

John Wein,

B. Sc. Wirtschaftsingenieurwesen
Carl-Zeiss-Straße 25

48432 Rheine

Phone: +49 5971 798 7437

Mobile: +49 151 62489605

E-mail: j.wein@ktr.com

Emsland, Mitte- und Süd-Niedersachsen, Ostwestfalen

Rainer Lüttmann

KTR Systems GmbH
Carl-Zeiss-Straße 25

48432 Rheine

Phone: +49 5971 798-340

Mobile: +49 172 5322164

E-mail: r.luettmann@ktr.com

NRW: Süd, Westfalen und Nordhessen

René Szabó,

Techniker u. techn. Betriebswirt (IHK)
Waldstr. 67

57080 Siegen-Niederschelden

Phone: +49 5971 798 7777

Mobile: +49 175 81 64 844

E-mail: r.szabo@ktr.com

Hessen, Rheinland-Pfalz, Saarland

Martin Dietrich, Ingenieur Maschinenbau
KTR Ingenieurbüro Frankfurt

Schorbachstr. 9
35510 Butzbach

Phone: +49 6033 9248494

Mobile: +49 172 5329968

E-mail: m.dietrich@ktr.com

Berlin, Mecklenburg-Vorpommern Südost, Sachsen-Anhalt, Brandenburg

Thüringen Nord, Sachsen
Norman Schlag, Tech. BW (IHK)

KTR Ingenieurbüro Leipzig
Hauptstraße 101

04416 Markkleeberg

Phone: +49 341 35416467

Mobile: +49 173 4716266

E-mail: n.schlag@ktr.com

Baden-Württemberg Nord

Eberhard Maier, Dipl.-Ing. (FH)
Hortensienweg 1

70374 Stuttgart, Sommerrain

Phone: +49 71 16 5842957

Mobile: +49 172 5355056

E-mail: e.maier@ktr.com

Baden-Württemberg Süd

Jochen Glöckler, Maschinenbautechniker
KTR Ingenieurbüro Balingen

Hölzlestraße 44
72336 Balingen

Phone: +49 7433 91381

Mobile: +49 172 5310049

E-mail: j.gloeckler@ktr.com

Bayern-Nord, Thüringen Süd

Alexander Ennulat, Dipl.-Ing.
KTR Ingenieurbüro Römerstein

Grabenstetter Str. 28
72587 Römerstein

Phone: +49 7382 9369226

Mobile: +49 162 4160354

E-mail: a.ennulat@ktr.com

Bayern-Süd, Baden-Württemberg Ost

Peter Benkard, Dipl.-Ing. (FH)
KTR Ingenieurbüro Adelsried

Am Mittelfeld 13
86477 Adelsried

Phone: +49 8293 9605-04

Mobile: +49 172 5313059

E-mail: p.benkard@ktr.com

For all representatives and sales partners refer to www.ktr.com.

KTR worldwide:

Algeria

KTR Algérie
Phone: +213 661 92 24 00
Phone: +33 4 78 64 54 66
E-mail: ktr-dz@ktr.com

Brazil

KTR do Brasil Ltda.
Rua Jandaia do Sul 471 -
Bairro Emiliano Perneta
Pinhais - PR - Cep: 83324-440
Phone: +55 41 36 69 57 13
E-mail: ktr-br@ktr.com

Chile

KTR Systems Chile SpA
Calle Bucarest 17
Oficina 33 Providencia
Santiago de Chile
Phone: +56 23 22 46 674
Mobile: +56 9 44 75 57 02
E-mail: ktr-cl@ktr.com

China

KTR Power Transmission Technology
(Shanghai) Co. Ltd.
Building 1005, ZOBON Business Park
999 Wangqiao Road
Pudong
Shanghai 201201
Phone: +86 21 58 38 18 00
Fax: +86 21 58 38 19 00
E-mail: ktr-cn@ktr.com

Czech Republic

KTR CR, spol. s r.o.
Brněnská 559
569 43 Jevíčko
Czech Republic
Phone: +420 461 325 014
E-mail: ktr-cz@ktr.com

Denmark

KTR Systems Danmark ApS
Vejløvej 51, Bygning N
8600 Silkeborg
Phone: +45 39 39 10 50
E-mail: ktr-dk@ktr.com

Finland

KTR Finland OY
Tiistinniityntie 4
FIN-02230 Espoo
Phone: +358 2 07 41 46 10
E-mail: ktr-fi@ktr.com

France

KTR France SAS
5 Chemin de la Brocardière
CS 71359
F-69573 DARDILLY CEDEX
Phone: +33 4 78 64 54 66
Fax: +33 4 78 64 54 31
E-mail: ktr-fr@ktr.com

India

KTR Couplings (India) Pvt. Ltd.,
T - 36 / 37 / 38 / 39, MIDC Bhosari,
Pune Maharashtra 411026
Phone: +91 20 27 12 73 24 / 25
Fax: +91 20 27 12 73 23
E-mail: ktr-in@ktr.com;
india.sales@ktr.com

Italy

KTR Systems GmbH
Sede Secondaria Italia
Via Giacomo Brodolini, 8
I - 40133 Bologna (BO)
Phone: +39 051 613 32 32
Fax: +39 051 298 55 77
E-mail: ktr-it@ktr.com

Japan

KTR Japan Co., Ltd.
c/o The Sumitomo Warehouse Co., Ltd.
Kobe Branch, Chuo Logistics Center L-6
7-14 Minatojima, Chuo-ku, Kobe City,
Hyogo 650-0045 Japan
Phone: +81 78 381 84 01
Fax: +81 78 945 85 60
E-mail: ktr-jp@ktr.com

Korea

KTR Korea Ltd.
#604, Songwon bldg., 89-10,
Galmaejungang-ro, Guri-si,
Gyeonggi-do, 11901 Korea
Phone: +82 3 15 69 45 10
Fax: +82 3 15 69 45 25
E-mail: ktr-kr@ktr.com

Netherlands

KTR Benelux B. V.
Postbus 87
Oosterveldsingel 3
NL-7558 PJ Hengelo (O)
Phone: +31 74 2553680
E-mail: ktr-nl@ktr.com

Norway

KTR Systems Norge AS
Lahaugmoveien 81
N-2013 Skjetten
Phone: +47 64 83 54 90
E-mail: ktr-no@ktr.com

Poland

KTR Polska Sp. z o.o.
ul. Czerwone Maki 65
PL-30-392 Kraków
Phone: +48 12 267 28 83
E-mail: ktr-pl@ktr.com

Singapore

KTR Systems Singapore Pte. Ltd.
2 Venture Drive
#13-02 Vision Exchange
Singapore 608526
Phone: +65 69 04 12 32
Mobile: +65 96 33 66 92
E-mail: a.low@ktr.com

South Africa

KTR Couplings SA (Pty) Ltd.
28 Spartan Road, Kempton Park,
Spartan Ext. 21
Phone: +27 11 281 3801
Fax: +27 11 281 3812
E-mail: ktr-za@ktr.com

Spain

KTR Systems GmbH
Estartetxe, nº 5-Oficina 322
E-48940 Leioa (Vizcaya)
Phone: +34 9 44 80 39 09
Fax: +34 9 44 31 68 07
E-mail: ktr-es@ktr.com

Sweden

KTR Sverige AB
Box 7010
S-187 11 Täby
Phone: +46 86 25 02 90
E-mail: info.se@ktr.com

Switzerland

KTR Systems Schweiz AG
Bahnstr. 60
CH-8105 Regensdorf
Phone: +41 4 33 11 15 48
Fax: +41 4 33 11 15 56
E-mail: ktr-ch@ktr.com

Taiwan

KTR Taiwan Ltd.
No. 30-1, 36 Rd., Taichung Industry Zone,
Xitun Dist., Taichung City 40768,
Taiwan (R.O.C)
Phone: +886 4 23 59 32 78
Fax: +886 4 23 59 75 88
E-mail: ktr-tw@ktr.com

Turkey

KTR Turkey
Güç Aktarma Sistemleri San. ve Tic. Ltd.
Sti. Kayışdağı Cad. No: 117/2
34758 Atasehir -Istanbul
Phone: +90 216 574 37 80
Fax: +90 216 574 34 45
E-mail: ktr-tr@ktr.com

United Kingdom

KTR U.K. Ltd.
Robert House
Unit 7, Acorn Business Park
Woodseats Close
Sheffield
United Kingdom, S8 0TB
Phone: +44 11 42 58 77 57
Fax: +44 11 42 58 77 40
E-mail: ktr-uk@ktr.com

USA

KTR Corporation
122 Anchor Road
Michigan City, Indiana 46360
Phone: +1 2 19 8 72 91 00
Fax: +1 2 19 8 72 91 50
E-mail: ktr-us@ktr.com

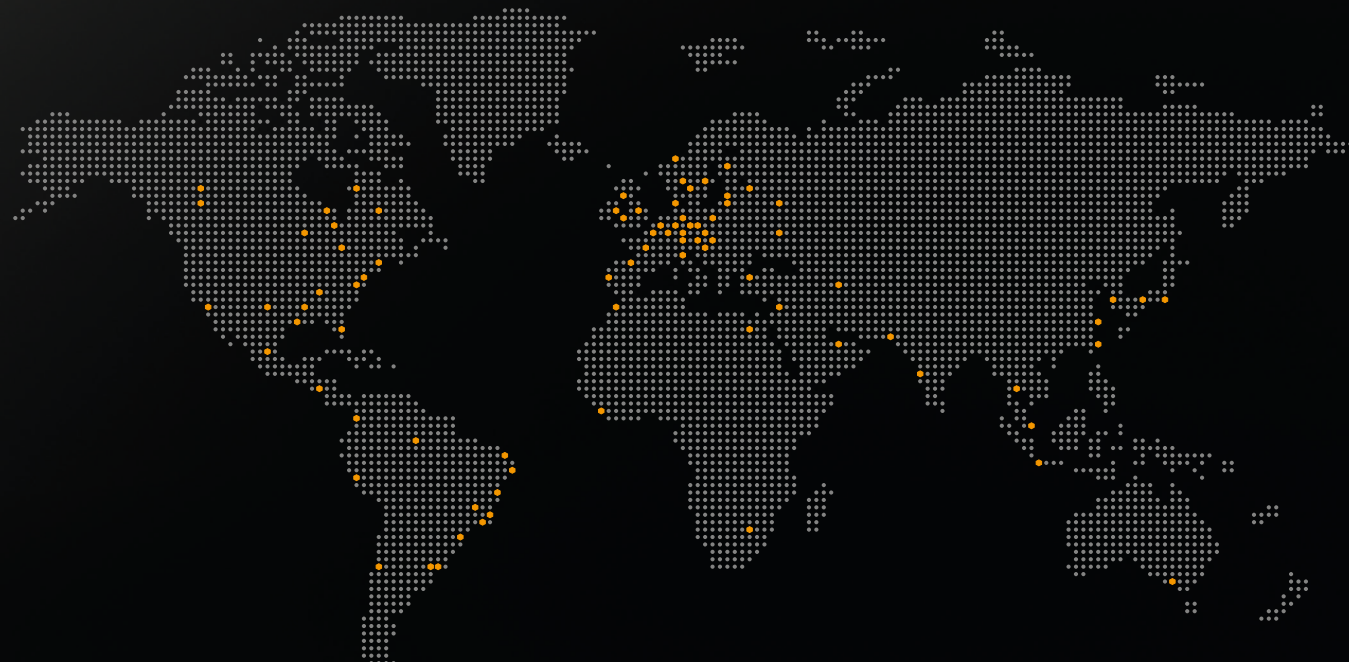



Headquarters

KTR Systems GmbH

Carl-Zeiss-Straße 25

D-48432 Rheine

Phone: +49 5971 798-0

Fax: +49 5971 798-698 or 798-450

E-mail: mail@ktr.com

Internet: www.ktr.com

Made for Motion



Certificates and approvals of our varied products

Being one of the first companies in the field of drive technology, KTR was certified in accordance with DIN EN ISO 9001 already in 1993, including the plants in Poland, China, India and USA.

Currently KTR products have been approved by numerous internationally renowned societies for standardization and classification. Individual approvals by other societies can be implemented on request without fail.



Legend of pictograms



torsionally stiff



light-weight



maintenance-free



torsionally flexible

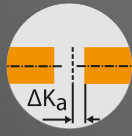

axial compensation



protected against corrosion



highly flexible



angular compensation



electrically insulating



damping vibrations

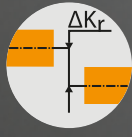

radial compensation



maximum speed



axial plug-in



shiftable at standstill



no eddy current losses



consider shaft distance



double-cardanic



torque limiter slipping



relatively short shaft distance

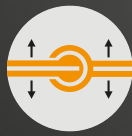

radial disassembly, ease of service



torque limiter with synchronous ratcheting

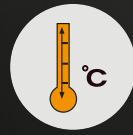

maximum operating temperature



standard drop-out centre lengths available



torque limiter with idle rotation type



high speeds



available in accordance with API



hardened surface



backlash-free



complying with ATEX for details refer to our ATEX leaflet



accuracy X %



shear type, separating, slipping



certified in accordance with ABS



consider axial displacement



additional features compared to standard version